

## NEW XRE41\_P003000

Our new XRE41 is a quiet, high performance pump for your electrical applications.



- ▶ Specially adapted for mounting on electric power take-off (ePTO).
- ▶ Piston pump with a displacement of 41 cm<sup>3</sup>.
- ▶ 9-piston design to reduce pulsation and lower noise level.
- ▶ Innovative distribution for more performance.
- ▶ Use of high strength materials
- ▶ Reinforced sealing
- ▶ High self priming speed
- ▶ Reduced footprint
- ▶ Original synchronization between the plate and the barrel
- ▶ 2" suction connection supplied with the pump
- ▶ Flange and shaft for truck application, according to DIN ISO 14/ NF E22-131

### Technical characteristics :

Reference	Sens de rotation	Direction of rotation (cm <sup>3</sup> /tr)	Max. continuous pressure (bar)	Maximum intermittent peak pressure < 5 seconds (bar)	Max. speed <sup>(1)</sup> (rpm)	Max. absorbed torque at 380 bar (N.m)	Weight		Overhang torque	
							Without inlet fitting (kg)	With inlet fitting 2" (kg)	Without inlet fitting (N.m)	With inlet fitting 2" (N.m)
XRE41_P003000	Droite (SH)	41,2	400	450	2800	262,29	10,44	11	10,15	11,42

(1) At absolute pressure 1 bar, ISO VG46 fluid at 25°C.

### Dimensions in mm [inches] :

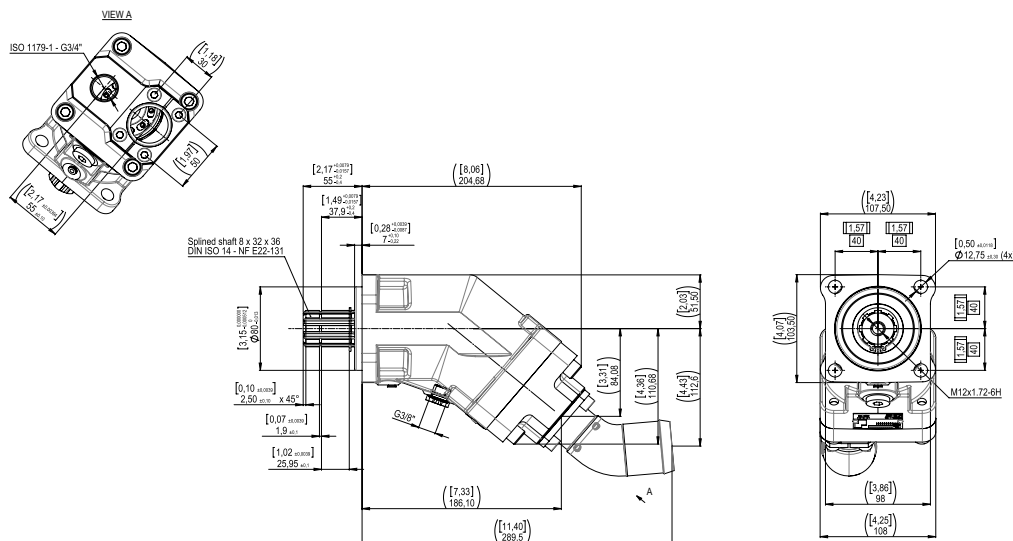

Dimensions in mm [inches] are given only as an indication.

For further information, please contact Customer Service (+33(0)3 83 76 77 40).

**HYDRO LEDUC SAS**  
Siège social & Usine  
Head Office and Factory  
BP 9  
F-54122 AZERAILLES  
FRANCE  
Tel. +33 (0)3 83 76 77 40  
Fax +33 (0)3 83 75 21 58

**HYDRO LEDUC GmbH**  
Am Ziegelplatz 20  
D-77746 SCHUTTERWALD  
DEUTSCHLAND  
Tel. +49 (0) 781-9482590  
Fax +49 (0) 781-9482592

**HYDRO LEDUC AB**  
Betongvägen 11  
461 38 TROLLHÄTTAN  
SWEDEN  
Tel. + 46 (0) 520 10 820

**HYDRO LEDUC BV**  
Ericssonstraat 2  
5121 ML Rijen  
The Netherlands  
Tel. +31 6 202 40 651

**HYDRO LEDUC N.A. Inc.**  
Grand Parkway Industrial Park  
23549 Clay Road  
KATY, TX 77493  
USA  
Tel. +1 281 679 9654



[www.hydroleduc.com](http://www.hydroleduc.com)